

Midwest Association
for Public Opinion Research



46th Annual Conference
Reconnecting and Reevaluating:
Assessing the Foundations and
Future of Public Opinion Research

Interim Program

November 19-20, 2021
Embassy Suites Downtown Chicago
600 N. State Street
Chicago, IL 60654

Share your conference experience by tagging #MAPOR21

Facebook: @MidwestAPOR

Twitter: @MidwestMAPOR

CONFERENCE AT A GLANCE

FRIDAY, NOVEMBER 19

7:30 AM – 8:00 AM	Lakeview	Early Registration for Short Course and Interaction Working Group
7:40 AM – 10:00 AM	Outside DePaul	Refreshments
8:00 AM – 5:30 PM	Business Center	Sponsor Exhibit
8:00 AM – 10:00 AM	Lincoln Park	Short Course Allyson Holbrook, University of Illinois at Chicago: “Questionnaire Design: Theoretical Paradigms and Best Practices” (registration required)
8:00 AM – 4:30 PM	Atrium South	General Registration
10:15 AM – 11:45 AM	DePaul	Recruiting and Representing Hard to Reach Populations
	Lakeview	Examining the Cause and Effects of Discrimination
	Rivernorth A	Public Attitudes Towards Covid-19, Vaccines, and Masks
	Rivernorth B	
12:00 PM – 1:00 PM	Atrium North	Networking Lunch Buffet (ticket required)
1:15 PM – 2:45 PM	DePaul	Don’t Just Mail It In: Effective Respondent Recruitment
	Lakeview	More Than Memes and Boomerangs: Social Media Research
	Lincoln Park	Exploring Public Attitudes Toward Sexuality, Religion, and Moral Values
	Rivernorth A	The Impact of Media, News, and Information on Attitudes Toward Covid-19
	Rivernorth B	
2:45 PM – 3:00 PM	Outside DePaul	Break and Refreshments

3:00 PM – 4:30 PM	Rivernorth BCD	Student Paper & MAPOR Fellow Awards Keynote Speaker Nora Cate Shaeffer, University of Wisconsin: “An Essential Question...”
4:30 PM – 5:30 PM	Atrium South	President’s Reception (Complimentary wine,beer, and soft drinks) Sponsor Tables Student Conference Registration Raffle

SATURDAY, NOVEMBER 20

8:00 AM – 3:00 PM	Atrium South	General Registration
8:00 AM – 10:00 AM	Outside DePaul	Refreshments
8:30 AM – 10:00 AM	DePaul	Flipping the Script: Probing Into Interviewing Training and Effects
	Lakeview	Big Data: Big Opportunities and Big Challenges
	Lincoln Park	Democratic Elections
	Rivernorth A	Information and Misinformation
	Rivernorth B	
10:15 AM–11:45 AM	DePaul	Questionnaire Design: Small Details, Big Effects
	Lakeview	How is That Data?: Exploring Data Quality and Survey Validity
	Lincoln Park	Measuring Ideology and its Impact on Public Opinion
	Rivernorth A	Speed Networking
	Rivernorth B	
11:45 AM – 1:15 PM		Lunch (on your own)
1:30 PM – 2:30 PM	Rivernorth BCD	Pedagogy Hour Julie Andsager, University of Tennessee: “Same as it ever was? Public opinion perspectives then, now, and then again.”
2:30 PM – 2:45 PM	Outside DePaul	Break and Refreshments
2:45 PM – 4:15 PM	DePaul	Open for in memoriam

Lakeview	Who are We Interviewing?: Evaluating Survey Representativeness
Lincoln Park	Who You Gonna Trust?: Appeals, Persuasion, and Credibility
Rivernorth A	Can't We All Get Along?: International Conflicts and Public Opinion
Rivernorth B	Cook County Community Survey: Enduring and Emerging Issues in Chicago and Suburban Cook County
4:30 PM – 5:30 PM	Lakeview Annual Member Meeting

Map of the Embassy Suites

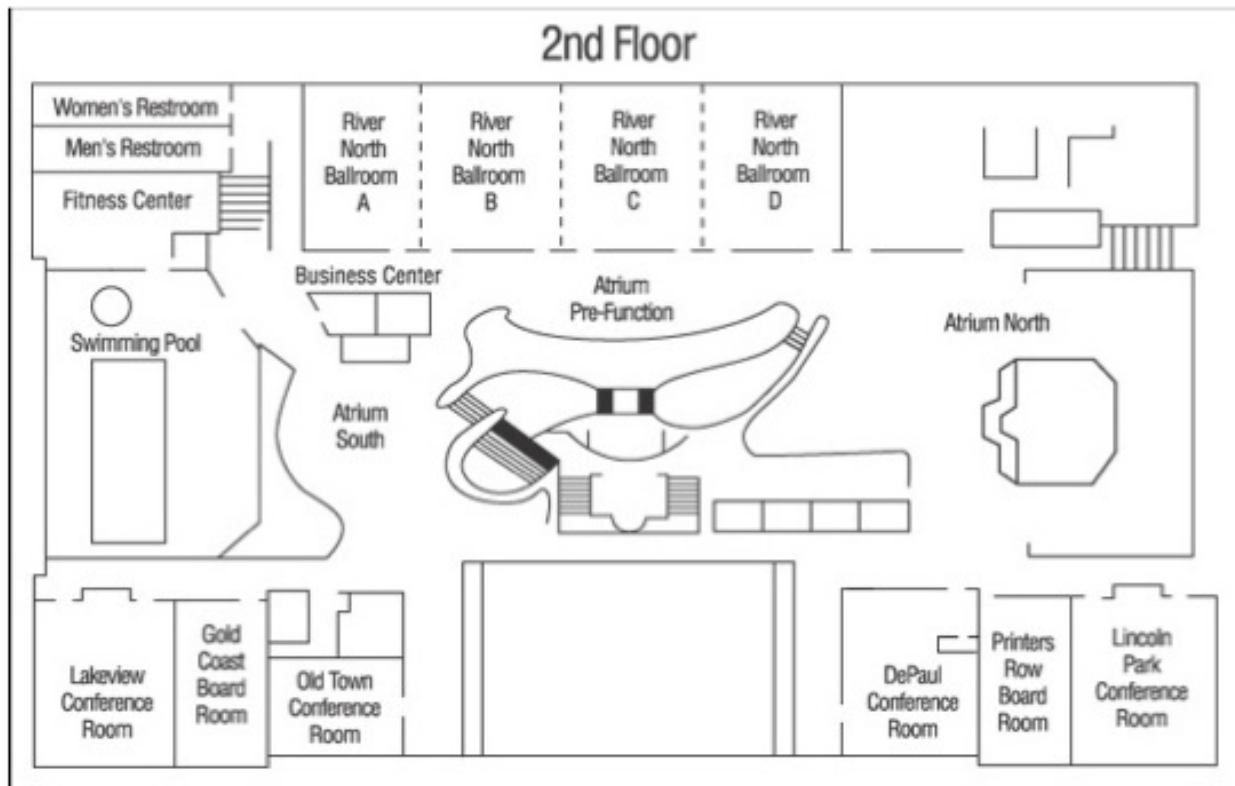

Conference Sponsors

MAPOR acknowledges and thanks the following organizations for sponsoring the 2021 conference. Your support ensures that MAPOR can continue to offer a successful conference each year!

Gold Level Sponsors

Ipsos Public Affairs

NORC at the University of Chicago

Silver Level Sponsors

Dynata

EdChoice

Marketing Systems Group

RTI International

The Nielsen Company

University of Chicago Survey Lab

University of Michigan Program in Survey and Data Science

University of Wisconsin Survey Center

Bronze Level Sponsors

Indiana University Center for Survey Research

Michigan State University, Institute for Public Policy and Social Research, Office for Survey Research

ReconMR-Reconnaissance Market Research

Research Support Services, Inc.

University of Nebraska - Bureau of Sociological Research

University of Northern Iowa, Center for Social & Behavioral Research

MAPOR Officers

President	Dana Garbarski, Loyola University Chicago
Vice-President/President-Elect	Kevin Ulrich, University of Chicago Survey Lab
Past President	Ned English, NORC at the University of Chicago
Conference Chair	David Sterrett, NORC at the University of Chicago
Associate Conference Chair	Leah Dean, RTI International
Secretary-Treasurer	Lindsey Witt-Swanson, University of Nebraska-Lincoln
Member-at-Large	Sarah Walsh, NORC at the University of Chicago
Member-at-Large	Ed Ledek, Clear Insights Group
Member-at-Large	Hillary Hanson, University of Chicago Survey Lab
Member-at-Large	Bob Davis, Davis Research
Webinars Coordinator & Webmaster	Y. Patrick Hsieh, RTI International
Communications Coordinator	Justine Bulgar-Medina, NORC at the University of Chicago
Corporate Sponsor Coordinator	John Stevenson, University of Wisconsin
Student Liaison	Evgenia Kapousouz, University of Illinois at Chicago

DETAILED SCHEDULE | FRIDAY NOVEMBER 19, 2021

Refreshments — Outside DePaul **Friday, 7:40 AM – 10:00AM**

Sponsored by the University of Wisconsin Survey Center

Short Course (registration required) **Friday, 8:00 AM – 10:00AM**

Sponsored by the University of Chicago Survey Lab

Short Course: “Questionnaire Design: Theoretical Paradigms and Best Practices” **Lincoln Park**

Presenter: Allyson Holbrook, University of Illinois at Chicago

Paper Session 1 **Friday, 10:15 AM – 11:45 AM**

Recruiting and Representing Hard to Reach Populations **DePaul**

Moderator:

Clarify of Vision: How Well Do Online Samples Represent People of Color in the US?

Frances Barlas, Ipsos Public Affairs; Larry Osborn, Ipsos Public Affairs; Randall K. Thomas, Ipsos Public Affairs; Megan Hendrich, Ipsos Public Affairs

Lesbian Political Identity as a Matter of Public Opinion Research

Maya Novak-Herzon, Northwestern University; Caroline Pippert, Northwestern University

The Urban-Rural Digital Divide in Internet Access and Online Activities During the Covid-19 Pandemic

Angelica Phillips, University of Nebraska-Lincoln; Kristen Olson, University of Nebraska-Lincoln, Jolene Smyth, University of Nebraska-Lincoln; Rachel Stenger, RTI International

Navigating a Limited Field: Utilizing Photo Diary to Virtually Connect to Hard-to-Reach Populations

Emily Baker, Nielsen; Lauren Walton, Nielsen; Stephanie Melton, Nielsen

Improving Online Survey Access and Equitability for People with Disabilities

Nathan Wiggin, ComEngage, LLC

Chair:

Being Ground Down: The Impact of Demographics and Discrimination Experiences on Quality of Life

Cynthia Pelayo, Ipsos Public Affairs; Randall K. Thomas, Ipsos Public Affairs; Jazz Stephens, Ipsos Public Affairs; Frances M. Barlas, Ipsos Public Affairs

Beyond Busing: The Continued Significance of Racial Prejudice in White Education Policy Preferences

Andrea Manning, University of Illinois-Chicago; Isaac Pollert, University of Illinois-Chicago; Tingting Ding, University of Illinois-Chicago; Beyza Buyuker, University of Illinois-Chicago; Alexandra Filindra, University of Illinois-Chicago

Media and Modern Racism: Understanding Anti-Asian Attitudes During the COVID-19 Pandemic

Jian Shi, Syracuse University; Lars Willnat, Syracuse University

You Are What You Feel: Impact of Demographics and Discrimination Events on Affective Experience

Jazz Stephens, Ipsos Public Affairs; Randall K. Thomas, Ipsos Public Affairs; Frances M. Barlas, Ipsos Public Affairs; Cynthia Pelayo, Ipsos Public Affairs

Public Attitudes Toward Covid-19, Vaccines, and Masks

Rivernorth A

Chair:

Examining the effects of political polarization on US public opinion towards the Covid-19 pandemic

Ryan Tully, Ipsos Public Affairs; Frances Barlas, Ipsos Public Affairs; Randall K. Thomas, Ipsos Public Affairs

Vaccine Attitudes in Cross-National Perspective: A Latent Class Analysis

Tim Gravelle, Momentive; Joseph B. Phillips, University of Exeter; Jason Reifler, University of Exeter; Thomas J. Scotto, University of Glasgow

The person behind the mask: Exploring public opinion surrounding CDC recommended behaviors

Derrick Holland, University of Tennessee; Shelby Luttmann, University of Tennessee

The Effects of the COVID Pandemic on the Mental Health of Nebraskans

Lindsey Witt-Swanson, University of Nebraska-Lincoln; Rachel Rogers, University of Nebraska-Lincoln; Alex Henkel, University of Nebraska-Lincoln; Emily Starr, University of Nebraska-Lincoln; Eli Ornelas, University of Nebraska-Lincoln

Who's Willing to get Vaccinated? Exploring Differences within Parties

Branded URL: Garnish or essential ingredient for push-to-web?

Lacie Hines, CSBR at the University of Northern Iowa; Matthew Gunderson, CSBR at the University of Northern Iowa

“We Have Been Trying to Reach You”: How Screening Services Impact Telephone Survey Response Rates

Alyssa McCoy, University of Northern Iowa; Rod Muilenburg, University of Northern Iowa; Erin Heiden, University of Northern Iowa; Ki Park, University of Northern Iowa; Mary Losch, University of Northern Iowa

More Than Memes and Boomerangs: Social Media Research

Lakeview

Chair:

Examining the Relationship Between Mobile Messaging, Political Efficacy, & Contentious Participation

Oluseyi Adegbola, DePaul University; Sherice Gearhart, Texas Tech University

Candidate Signaling and Polling - What Google Trends Can Tell Us

Robert Schultz, University of Michigan; Paul Lavrakas, University of Illinois-Chicago

Pandemic-associated Stigmatization: Semantic Network Analysis on Twitter Discourses of Chinese Virus

Jian Shi, Syracuse University; Hanxiao Wang, Nanjing Normal University

College Students’ Political Use of Instagram: A Uses and Gratifications Approach

Moonsun Choi, University of New Mexico; Yangsun Hong, University of New Mexico; Hyerin Kwon, University of Wisconsin

Social Media and News Coverage of Presidential Campaigns: A Study of the 2020 U.S. Election

Heloisa Wilkerson, Purdue University-Fort Wayne

Exploring Public Attitudes Toward Sexuality, Religion, and Moral Values

Lincoln Park

Chair:

Moralized Attitudes at the Intersection of Science and Society

Robin Xu Bayes, Northwestern University

Large Linear Trends in Public Opinion: The Case of Views Towards Gays and Lesbians

Caroline Pippert, Northwestern University

Examining how question context reveals nuances in public attitudes towards legal abortion

Semilla Stripp, NORC at the University of Chicago; Marjorie Connelly, NORC at the University of Chicago; Betsy Broaddus, NORC at the University of Chicago; David Sterrett, NORC at the University of Chicago

Secularization around the World

Tom W. Smith, NORC at the University of Chicago; Benjamin Shapiro, NORC at the University of Chicago

The Impact of the Media, News, and Information on Attitudes Toward Covid-19

Rivernorth A

Chair:

Exploring the path of media use, misinformation, anger, and risk perception on COVID-19 during a pan

Soo Yun Kim, University of Wisconsin-Madison; Jisoo Kim, University of Wisconsin-Madison; Kwansik Mun, University of Wisconsin-Madison; Hyesung Lee, University of Wisconsin-Madison; Hernando Rojas, University of Wisconsin-Madison

Information-seeking behavior and attitudes toward COVID vaccination

Michael McCluskey, University of Tennessee at Chattanooga; Nagwan R. Zahry, University of Tennessee at Chattanooga

Inoculating against Covid-19 vaccine hesitancy: Examining the role of news consumption, political conservatism, and religiosity in Covid-19 vaccine hesitancy

Kami M. Vinton, University of Texas at Austin; Karishma Chatterjee, University of Texas at Arlington

Communicating the pandemic: The presentation of COVID-19 in news media and social media

Sang-Hwa Oh, University of Illinois at Urbana-Champaign; Hyun-Jeong Hwang, Seoul National University; Soojong Kim, Stanford Center on Philanthropy and Civil Society; Chul-joo Lee, Seoul National University

Local TV News and the COVID-19 Vaccines: Communicating Data in America's Most Trusted News Source

Aaron Veenstra, Florida Atlantic University; Haley Tiso, Florida Atlantic University; Madeleine Wagner, Florida Atlantic University; Mazrukh Khan, Florida Atlantic University

Effects of the “flatten the curve” charts on perceptions of social distancing measures

Li Nan, University of Wisconsin-Madison; Amanda L. Molder, University of Wisconsin-Madison

Break and Refreshments	Outside DePaul	Friday, 2:45 PM – 3:00 PM
-------------------------------	-----------------------	----------------------------------

Sponsored by Marketing Systems Group

Enjoy freshly brewed coffee, tea, and water, as well as tasty desserts.

Annual Address	Rivernorth BCD	Friday, 3:00 PM – 4:30 PM
-----------------------	-----------------------	----------------------------------

Sponsored by NORC at the University of Chicago

Presentation of Awards and New MAPOR Fellow Announced

Keynote Address: “An Essential Question...”

Nora Cate Schaeffer

Sewell Bascom Professor of Sociology, Emerita, University of Wisconsin-Madison

President’s Reception	Atrium South	Friday, 4:30 PM – 5:30 PM
------------------------------	---------------------	----------------------------------

Sponsored by The Nielsen Company

Join us for complimentary drinks and appetizers and celebrate MAPOR’s 464th birthday!

Student Conference Registration Raffle	Atrium South	Friday, 5:30 PM
---	---------------------	------------------------

Sponsored by the University of Michigan Program in Survey Methodology

MAPOR’s student members are automatically entered into a raffle for free registration for next year’s MAPOR conference!

DETAILED SCHEDULE | SATURDAY NOVEMBER 20, 2021

Refreshments	Outside DePaul	Saturday, 8:00 AM – 10:00AM
--------------	----------------	-----------------------------

Sponsored by RTI International

Enjoy refreshments to start the morning.

Paper Session 3	Saturday, 8:30 AM – 10:00 AM
-----------------	------------------------------

**Flipping the Script: Probing into
Interviewer Training and Effects**

DePaul

Chair:

**The Show Must Go On: Successful Strategies for Collecting Data During the
COVID-19 Pandemic**

Karen Tucker, Indiana University; Mary Ellen Van Booven, Indiana University; Kim Meyer, Indiana University; Kevin Tharp, Indiana University; Inna Kouper, Indiana University

**Zooming Towards the Future of Remote Data Collection Interviewer (DCI)
Training**

Bethany van Spronsen, RTI International; Alyson Miller, RTI International

Effects of Interviewer Language and Dialect on Questions About Political Trust

Mao Li, University of Michigan; Victoria Lauren Owens, Westat

**Examining interviewer-respondent interactions across question sensitivity and
respondents' race**

Tiffany Neman, University of Wisconsin-Madison; Jennifer Dykema, University of Wisconsin-Madison; Dana Garbarski, Loyola University Chicago; Cameron Jones, University of Wisconsin-Madison; Nora Cate Schaeffer, University of Wisconsin-Madison

Big Data: Big Opportunities and Big Challenges

Lakeview

Chair:

**Making big data useful for research: A framework for evaluating and considering
big data sources**

Leah Christian, NORC at the University of Chicago; David Dutwin, NORC at the University of Chicago; Josie Bechara, NORC at the University of Chicago

**Utilizing Big Data in Survey Research: Efficient Targeting of Hard-to-Reach
Populations**

David Dutwin, NORC at the University of Chicago; Ipek Bilgen, NORC at the University of Chicago

Words Speak Louder Than Numbers: Estimating China's COVID-19 Severity with Deep Learning

Weifeng Zhong, Mercatus Center at George Mason University; Julian TszKin Chan, Bates White Economic Consulting; Kwan-Yuet Ho, Leidos; Kit Lee; Kawai Leung

Classifying and Validating If It's Funny or Not

Brendan Watson, VERN AI; Craig Tucker, VERN AI

Parametric and Tree-Based Models for Missing Data Imputation

Micha Fischer, University of Michigan

Can't we All Get Along?: International Conflicts and Public Opinion

Lincoln Park

Chair:

Where Does Japanese Cultural Nationalism Come From: A Mixed Method Study

Jiangxue Wang, University of Michigan

Media Coverage of the Territorial Dispute in the Asia-Pacific Region

Won Yong Jang, University of Wisconsin at Eau Claire; Edward Frederick, University of Wisconsin at Whitewater

Pride, Protect, and Pushbacks: Modeling Chinese Netizens' Opinions on the Sino-US Trade Dispute

Liwei Shen, University of Wisconsin-Madison; Xinle Jia, University of Wisconsin-Madison

Cross-Border Cues: The Influence of Foreign Partisans on Support for Border Restrictions

Tim Gravelle, Momentive; Isabel Williams, University of Arizona; Samara Klar, University of Arizona

Information and Misinformation

Rivernorth A

Chair:

Misinformation Confuses Others: Predictors of the Third-Person Effect During Presidential Election

Bingbing Zhang, Pennsylvania State University; Sherice Gearhart, Texas Tech University; Oluseyi Adegbola, DePaul University

Effects of Political Bias and Decision-Making Style on Belief in False News Claims and Support for Public Policies

Keith Lavine, Lewis University; Susan Sheffer, Lewis University; Steven Nawara, Lewis University

The role of news believability on the development of public opinion

Robin Blom, Ball State University

Political Efficacy, Conspiracy Beliefs and the Effects of Depression on Support for Capitol Rioters

Jennifer Lin, Northwestern University; Matthew A. Baum, Harvard University; James N. Druckman, Northwestern University; Matthew D. Simonson, Northeastern University; Roy H. Perlis, Harvard Medical School

How Americans Think About Journalists and the News Media Before and After Trump and Covid-19

Lars Willnat, Syracuse University; David Weaver, Indiana University

Using Experimental Vinettes to Study the Public's Reactions to and Evaluation of Public Opinion Polls

Paul J. Lavrakas, University of Illinois-Chicago; Allyson Holbrook, University of Illinois-Chicago; Tim Johnson, University of Illinois-Chicago; Young Cho, University of Wisconsin-Milwaukee; Henning Silber, GESIS

Paper Session 4

Saturday, 10:15 AM – 11:45 AM

Questionnaire Design: Small Details, Big Effects

DePaul

Chair:

“No Thank You, Next” – Item Nonresponse of Sensitive Topics in the General Social Survey

Maria Sanchez, NORC at the University of Chicago, Eyob Moges, NORC at the University of Chicago

Measuring Political Efficacy Using Agree-Disagree Versus Item-Specific Questions: Differences in Data Quality from Two Interviewer-Administered Surveys

Curtiss W. Enngstrom, University of Michigan; Jennifer Dykema, University of Wisconsin-Madison; Nora Cate Schaeffer, University of Wisconsin-Madison; Dana Garbarski, Loyola University Chicago

Would You? Could You? Did You? Measuring Hypothetical Bias in Opinion Surveys

Adam Kaderabek, University of Michigan; Jennifer Sinibaldi, National Center for Science and Engineering Statistics

It's All in the Numbers?: Examination of The New Numeric Response Format

Randall Thomas, Ipsos Public Affairs; Jazz Stephens, Ipsos Public Affairs; Megan Hendrich, Ipsos Public Affairs

What Parcel Tax Records Tell Us About Homeownership Measurement in Surveys

Zhang Shiyu, University of Michigan; James Wagner, University of Michigan;

Elisabeth R. Gerber, University of Michigan; Jeffrey D. Morenoff, University of Michigan

Negated and polar opposite items for balanced scale construction

Fernanda Alvarado-Leiton, University of Michigan

How is That Data?: Exploring Data Quality and Survey Validity

Lakeview

Chair:

Data quality and respondent experience in prerecorded video “interviews”

Fred Conrad, University of Michigan; Michael Schober, The New School; Andrew Hupp, University of Michigan; Brady West, University of Michigan; Kallan Larsen, University of Michigan

Does Data Cleaning Improve or Diminish Data Quality for Sub-groups?

Poom Nukulki, Ipsos Public Affairs; Randall K. Thomas, Ipsos Public Affairs; Frances M. Barlas, Ipsos Public Affairs; Megan Hendrich, Ipsos Public Affairs

Studying Open-Ended Codes Across Different Coding Teams: Analysis from the 2016-2020 GSS Panel

Ben Shapiro, NORC at the University of Chicago; Deanna Christianson, NORC at the University of Chicago; Abigail Norling, NORC at the University of Chicago

Social Desirability Bias: Questionnaire, Personality, or Cultural Trait?

Evgenia Kapousouz, University of Illinois-Chicago; Timothy Johnson, University of Illinois-Chicago

Factors Associated With Expressed Likelihood to Participate in Biomarker Survey Research

Cameron Jones, University of Wisconsin-Madison; Jennifer Dykema, University of Wisconsin-Madison; Dana Garbarski, Loyola University Chicago; Dorothy Farrar-Edwards, University of Wisconsin-Madison

It’s not you, it’s me

Eva Aizpurua, City, University of London; Ki H. Park, University of Northern Iowa; Erin O. Heiden, University of Northern Iowa; Mary E. Losch, University of Northern Iowa

Measuring Ideology and its Impact on Public Opinion

Lincoln Park

Chair:

The Dynamics of Meaning: A Textual Analysis of the Word “Conservative” in Mass Media

Tim Vance, Murray State University; Candace Vance, Murray State University

Measuring the political lense: Exploring a reliable and valid way to measure

political ideology

Derrick Holland, University of Tennessee

“How could anyone believe that?": Ideology and views of the other side's beliefs

Jeremy Levy, Northwestern University

Polarization of Public Trust in Scientists: A Cross-Decade Comparison Using Machine Learning

Nan Li, University of Wisconsin-Madison; Yachao Qian, University of Wisconsin-Madison

The Moderating Role of Democracy in the Relationship between Values and Political Attitudes

Eileen Wu, Northwestern University

Speed Networking

Rivernorth A

Chair:

Lunch

Saturday, 11:45 AM – 1:15 PM

On your own

Pedagogy Hour

Rivernorth BCD

Saturday, 1:30 PM – 2:30 PM

Sponsored by Ipsos Public Affairs

“Same as it ever was? Public opinion perspectives then, now, and then again”

Julie Andsager

University of Tennessee

Break and Refreshments

Outside DePaul

Saturday, 2:30 PM – 2:45 PM

Sponsored by Dynata

Enjoy freshly brewed coffee, tea, and water, as well as tasty desserts.

DePaul is open to begin to gather and reflect about MAPOR members lost this year.

Paper Session 5

Saturday, 2:45 PM – 4:15 PM

Open for in memoriam

DePaul

For those who continue to gather and reflect about MAPOR members lost this year.

Chair:

Beyond Asking Questions: Effectively Engaging Hard-to-Reach Populations

Amanda Templeton, Oklahoma City University

What Do Participants Want?: Understanding Motivations of Diverse Participants.

Larry Osborn, Ipsos Public Affairs; Seth Messinger, Ipsos Public Affairs; Randall K. Thomas, Ipsos Public Affairs; Mina Muller, Ipsos Public Affairs; Frances M. Barlas, Ipsos Public Affairs

A Methodological Evaluation of Using Web & Mail to Screen & Measure a National Probability Sample

Brady West, University of Michigan; Mick P. Couper, University of Michigan; William G. Axinn, University of Michigan; James Wagner, University of Michigan; Rebecca Gatward, University of Michigan

Local Bias: Examination of Data Validity Across Samples and Modes

Randall K. Thomas, Ipsos Public Affairs; Meng Li, Ipsos Public Affairs; Ying Wang, Ipsos Public Affairs; Frances M. Barlas, Ipsos Public Affairs

Harmonizing Modes - A Data Collection Best Practices Conversation

Daniel Rangel, ReconMR

Peekaboo!: The impact of displaying cash via window envelope during mail contact

Ipek Bilgen, NORC at the University of Chicago; David Dutwin, NORC at the University of Chicago; Roopam Singh, NORC at the University of Chicago; Erlina Hendarwan, NORC at the University of Chicago; Katie Young, NORC at the University of Chicago

Chair:

'Anger appeals' and public opinion: an experimental test in the context of artificial intelligence

Andrew Park, Seoul National University

How Public Skepticism and Value Appraisal Influence the Corporate Message Credibility (CSR)

Chris Yim, Loyola University-Chicago

Privacy Concerns? The Impact of Computational Advertising based on Product and Brand Variations

Kibum Youn, University of Tennessee-Knoxville

I Feel What You Feel: The Role of Empathetic Chatbot in Persuading Potential

Donors

Chris Yim, Loyola University-Chicago, Gain Park, Loyola University-Chicago

Doctoring Trust: the Associations between Belief in Traditional Medicine and Trust in Physicians

Li Chen, West Texas A&M University; Yafei Zhang, West Texas A&M University;
Xianwei Wu, University of Iowa

Democratic Elections

Rivernorth A

Chair:

How Public Opinion on Vote Buying Shapes Electoral Participation in Emerging Democracies

Oluseyi Adegbola, DePaul University; Sherice Gearhart, Texas Tech University

Do presidential elections induce public opinion? Empirical Evidence from Afghanistan

Rafiuddin Najam, Oregon State University

Economic Information in Retrospective Voting

Wei Zhong, George Washington University

2020 Presidential Support among Old Testament and New Testament Christians and Pseudo-Christians

Paul J. Lavrakas, University of Illinois-Chicago; Scott Richards; Reconnect Research

Cook County Community Survey: Enduring and Emerging Issues in Chicago and Suburban Cook County

Rivernorth B

Chair: Dana Garbarski

Cook County Community Survey: Motivations, pedagogy, and plans for the future

David Doherty, Loyola University Chicago; Dana Garbarski, Loyola University Chicago

Perceptions of neighborhoods and gentrification among Cook County residents

Sarah Jack, Loyola University Chicago

Perceptions of local environmental issues among Cook County residents

Juanita Vivas Bastidas, Loyola University Chicago

Policing and Criminal Justice: Perceptions of Cook County residents

Keyla Navarrete, Loyola University Chicago; Andrew Byrne, Loyola University Chicago

Annual Member Meeting

Lakeview

Saturday, 4:30 PM – 5:30 PM

MAPOR President Dana Garbarski will lead the annual member and business meeting.

MAPOR Fellows

1988 Doris Graber
1989 George Donahue, Clarice Olien &
Phillip Tichenor
1990 Jack McLeod
1992 Donna Charron
1993 David H. Weaver
1994 George Bishop
1996 Lee Becker
1997 Paul J. Lavrakas
1998 Leo Jeffres
1999 Mark Miller
2000 Cecilie Gaziano
2002 Michael Traugott
2003 Richard M. Perloff
2004 Robert P. Daves
2005 Sharon Dunwoody
2006 K. "Vish" Viswanath
2007 Allan L. McCutcheon
2008 Robert M. Groves
2010 Albert Gunther
2011 Stephen E. Everett
2012 Peter V. Miller
2013 Patricia Moy
2014 Tim Johnson
2015 Nora Cate Schaeffer
2016 Julie Andsager and Joe Murphy
2017 John Stevenson
2018 John Loft
2019 Tom Smith
2020 Ronald Langley

MAPOR Presidents

1976-77 Donna S. Charron
1977-78 George Bishop
1978-79 Gene Telser
1980-81 Doris Graber
1981-82 Andrew J. Morrison
1982-83 MariJean Suelzle
1983-84 Lee B. Becker
1984-85 Barbara A. Bardes
1985-86 D. Charles Whitney
1986-87 David H. Weaver
1987-88 Leo Jeffres
1988-89 Cecilie Gaziano
1989-90 Sharon Dunwoody
1990-91 M. Mark Miller
1991-92 Garrett O'Keefe
1992-93 Robert P. Daves
1993-94 Paul J. Lavrakas
1994-95 Richard M. Perloff
1995-96 William Elliott
1996-97 Ellen M. Dran
1997-98 Fiona Chew
1998-99 Sherry Marcy
1999-00 Stephen E. Everett
2000-01 William Rosenberg
2001-02 K. "Vish" Viswanath
2002-03 Julie Andsager
2003-04 Allan L. McCutcheon
2004-05 Douglas Blanks Hindman
2005-06 Dietram A. Scheufele
2006-07 David Tewksbury
2007-08 Ward Kay
2008-09 Patricia Moy
2009-10 Weiwu Zhang
2010-11 Timothy P. Johnson
2011-12 Michael Traugott
2012-13 Joe Murphy
2013-14 Kristen Olson
2014-15 Allyson Holbrook
2015-16 Trent Buskirk
2016-17 Matthew Courser
2017-18 Ron Langley
2018-19 Ipek Bilgen
2019-20 Ned English
2020-21 Dana Garbarski