

Midwest Association
for Public Opinion Research



47th Annual Conference
Turbulent Times: Public Opinion
Research in a Changing Landscape

Interim Program

November 18-19, 2022
Embassy Suites Downtown Chicago
600 N. State Street
Chicago, IL 60654

Share your conference experience by tagging #MAPOR22

Facebook: @MidwestAPOR

Twitter: @MidwestMAPOR

CONFERENCE AT A GLANCE

FRIDAY, NOVEMBER 18

7:30 AM – 8:00 AM	Lakeview	Early Registration for Short Course and Interaction Working Group
7:40 AM – 10:00 AM	Outside DePaul	Refreshments
8:00 AM – 5:30 PM	Business Center	Sponsor Exhibit
8:00 AM – 10:00 AM	Lincoln Park	Short Course Kristin Olson, University of Nebraska, Lincoln: “So You Want to Do a Mixed Mode Survey?: Considerations & Design Decisions When Mixing Web & Mail Mode” (registration required) 8:00 AM – 10:00 AM DePaul Short Course Chuck Shuttles, HyphaMetrics & Kristen Conrad, SSRS: “Budgeting 101: ‘Hands On’ Budget Development for Public Opinion Research” (registration required)
8:00 AM – 4:30 PM	Atrium South	General Registration
10:15 AM – 11:45 AM	Lakeview	Questionnaire Design: Implications for Data Quality
	Rivernorth A	We Can Do It!: Effects of Political and Information Efficacy on Civic Engagement
	Rivernorth B	Would You Like to Stick Around?: Opinion Panel Recruitment and Retention
12:00 PM – 1:00 PM	Atrium North	Lunch Buffet (ticket required)
1:15 PM – 2:45 PM	DePaul	Data Science and Statistical Methods for Improving Survey Data Quality
	Lakeview	This is Important: Agenda Setting and Message Framing for Public Opinion
	Lincoln Park	Cross Cultural Perspectives in Public Opinion Research
	Rivernorth A	Sample Sources and Data Quality

Rivernorth B

2:45 PM – 3:15 PM

Outside DePaul

Break and Refreshments
Networking Coffee Session

3:15 PM – 4:45 PM

Rivernorth BCD

Student Paper & MAPOR Fellow Awards
Keynote Speaker | Charles Franklin, Marquette University: “The Public Interest in Public Polling”

4:45 PM – 6:00 PM

Atrium South

President’s Reception (Complimentary wine, beer, and soft drinks)
Sponsor Tables
Poster Session
Student Conference Registration Raffle

SATURDAY, NOVEMBER 20

8:00 AM – 3:00 PM

Atrium South

General Registration

8:00 AM – 10:00 AM

Outside DePaul

Refreshments

8:30 AM – 10:00 AM

DePaul

Exploring Political Ideology and Polarized Public Opinion

Lakeview

Survey Mode Effects on Data Quality

Lincoln Park

Follow for More: Social Media and Public Opinion Research

Rivernorth A

Rivernorth B

10:15 AM–11:45 AM

DePaul

Exploring Public Opinion on Social, Economic, and Political Issues

Lakeview

Innovations in Contact Materials for Improving Data Quality

Lincoln Park

Exploring Race and Gender in the Context of Public Opinion Research

Rivernorth A

Speed Networking

Rivernorth B

11:45 AM – 1:15 PM

Lunch (on your own)

1:30 PM – 2:30 PM

Rivernorth BCD

Pedagogy Hour | Jill Dever, RTI International: “Mental & Substance Use Disorders Prevalence

Study: Using Probability and Nonprobability Sample Data to Enhance Coverage of the U.S. Adult Population”

2:30 PM – 2:45 PM	Outside DePaul	Break and Refreshments
2:45 PM – 4:15 PM	DePaul	Open for in memoriam
	Lakeview	Advancement in Data Collection Methods for Improving Data Quality
	Lincoln Park	Evaluating Effects of Question Format on Survey Responses
	Rivernorth A Rivernorth B	Sampling Techniques and Data Quality
4:30 PM – 5:30 PM	Rivernorth B	Annual Member Meeting

Map of the Embassy Suites

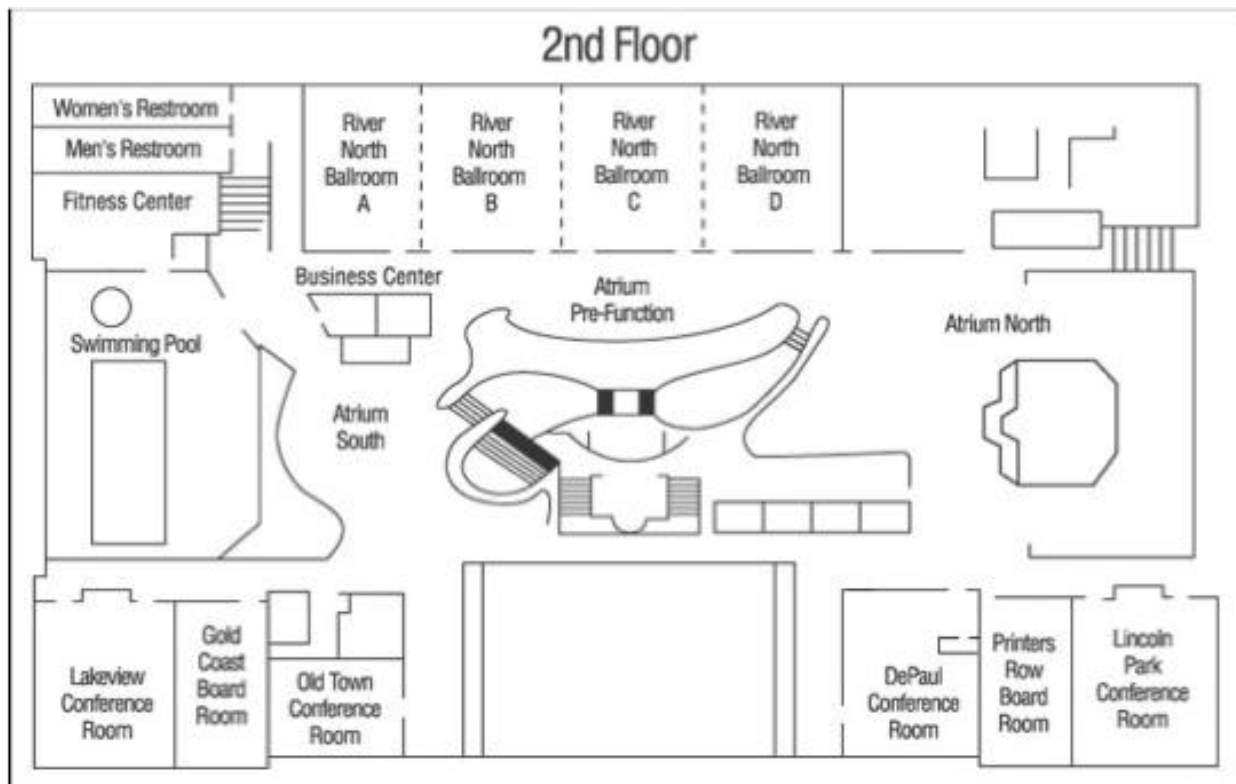

Conference Sponsors

MAPOR acknowledges and thanks the following organizations for sponsoring the 2022 conference.
Your support ensures that MAPOR can continue to offer a successful conference each year!

Gold Level Sponsors

EdChoice

Ipsos Public Affairs

Marketing Systems Group

NORC at the University of Chicago

Silver Level Sponsors

Dynata

Michigan Program in Survey and Data Science

NPC

ReconMR-Reconnaissance Market Research

RTI International

The Nielsen Company

University of Chicago Survey Lab

University of Michigan Institute for Social Research, Survey Research Operations

University of Wisconsin Survey Center

Bronze Level Sponsors

Indiana University Center for Survey Research

Michigan State University, Institute for Public Policy and Social Research, Office for Survey Research

Research Support Services, Inc.

University of Nebraska - Bureau of Sociological Research

University of Northern Iowa, Center for Social & Behavioral Research

MAPOR Officers

President	Kevin Ulrich, University of Chicago Survey Lab
Vice-President/President-Elect	Justine Bulgar-Medina, NORC at the University of Chicago
Past President	Dana Garbarski, Loyola University Chicago
Conference Chair	Leah Dean, RTI International
Associate Conference Chair	Y. Patrick Hsieh, RTI International
Secretary-Treasurer	Lindsey Witt-Swanson, NORC at the University of Chicago
Member-at-Large	David Sterrett, NORC at the University of Chicago
Member-at-Large	Rebecca Powell, RTI International
Member-at-Large	Erin Heiden, University of Northern Iowa
Member-at-Large	Bob Davis, Davis Research
Member-at-Large	Jerry Timbrook, RTI International
Webmaster	Hillary Hanson, University of Chicago Survey Lab
Communications Coordinator	Benjamin Schapiro, NORC at the University of Chicago
Student Liaison	Evgenia Kapousouz, University of Illinois at Chicago

DETAILED SCHEDULE | FRIDAY NOVEMBER 19, 2021

Refreshments — Outside DePaul **Friday, 7:40 AM – 10:00 AM**

Short Course (registration required) **Friday, 8:00 AM – 10:00 AM**

Short Course: “So You Want to Do A Mixed Mode Survey? Considerations & Design Decisions When Mixing Web & Mail Modes” **Lincoln Park**

Presenter: Kristin Olson, University of Nebraska - Lincoln

Short Course (registration required) **Friday, 8:00 AM – 10:00 AM**

Short Course: “Budgeting 101: ‘Hands On’ Budget Development for Public Opinion Research Projects” **DePaul**

Presenters: Chuck Shuttles, HyphaMetrics & Kristen Conrad, SSRS

Paper Session 1 **Friday, 10:15 AM – 11:45 AM**

Questionnaire Design: Implications for Data Quality Lakeview

Moderator: James Wagner

Question order and context effects when assistance to the poor and welfare are presented together

Jamy Rentschler, University of Nebraska Lincoln

Go Along to Get Along?: Sorry, Acquiescence Bias in Agreement Scales is Non-existent

Randall K. Thomas, Ipsos; Megan A. Hendrich, Ipsos

Designing Quasi-Filters for Open-Ended Numeric Survey Questions: An Experiment

Makena Nail, University of Nebraska-Lincoln

What do Social Desirability Scales Measure?

Evgenia Kapousouz, University of Illinois Chicago

Satisficing: Meaningless Noise or Impactful Biases?

Rishi Guharay, Civis Analytics

We Can Do It!: Effects of Political and Information Efficacy on Civic Engagement

Rivernorth A

Moderator: Allyson Holbrook

Civic participation among older adults: Applying Communication-Mediation Model

Heysung Lee, University of Wisconsin-Madison; Jaesung Lee, ASEM Global Ageing Center, Seoul, South Korea

Influencing public knowledge through eyewitness misidentification in news coverage

Robin Blom, Ball State University

Hopeful Pessimists: How U.S. Journalists Think About the Media and Democracy

Lars Willnat, Syracuse University; David Weaver, Indiana University, Bloomington

Do Accuracy-pursuing Citizens Always Hold Little Misperceptions? Experiments Manipulating Source Credibility

Suji Kang, Northwestern University

The Views of Young People on the Overturn of Abortion Rights and Its Impact on Political Participation

Rebecca Oh, The Generation Lab; Matin Mirramezani, The Generation Lab; Cyrus Beschloss, The Generation Lab

How Do Issue Characteristics Influence People's Reliance on Credible Source Cues?

Suji Kang, Northwestern University

Would You Like to Stick Around?: Opinion Panel Recruitment and Retention

Rivernorth B

Moderator: Alicia Frasier

Digital Device Usage: Insights from the General Population

Jim Clinton, Nielsen; Kay Ricci, Nielsen

Understanding the Effects of Panel Satisfaction on Panel Attrition and Retention

Jennifer Durow, Ipsos; Frances Barlas, Ipsos

The Quarterly Benchmark Survey: Understanding previously unidentified demographic subgroups in survey research

Amy Obendorf, Civis Analytics

Disentangling the Effects of Panel Conditioning and Panel Attrition

Jennifer Durow, Ipsos; Frances Barlas, Ipsos

Lunch Buffet

Atrium North

Friday, 12:00 PM - 1:00 PM

Make new connections or connect with old friends during our Grand Lunch Buffet host. Tables will be set up throughout the hotel mezzanine so that participants will be able to move around and socialize. The lunch is free for all students, and non-students must register for the event!

Paper Session 2

Friday, 1:15 PM – 2:45 PM

**Data Science and Statistical Methods for
Improving Survey Data Quality**

DePaul

Moderator: Jill Dever

Value-Based Pricing with Machine Learning Models

John V. Colias, Decision Analyst

Investigating, Explaining, and Predicting Belief in False Information

Paul Lavrakas, Steven Bucuvalas

AI's Discriminatory Practices and the Role of Corporate Ethical Climate

Sophie Blanchard, Loyola University Chicago

**Correcting for Mismatch Error in Linear Regression Models Fitted to Linked Data:
A New Approach**

Brady West, University of Michigan; Martin Slawski, George Mason University;
Emanuel Ben-David, U.S. Census Bureau; Zhenbang Wang, George Mason
University; Priyanjali Bukke, George Mason University

**Weighting adjustment for Person-Day Nonresponse: An Application to the National
Household Food Acquisition and Purchase Survey**

Jiazhi Yang, University of Michigan; Brady T. West, University of Michigan; Jeffrey
Gonzalez, U.S. Department of Agriculture; Yajuan Si, University of Michigan; Lauren
Miller, U.S. Department of Agriculture

**This is Important: Agenda Setting and
Message Framing for Public Opinion**

Lakeview

Moderator: John Stevenson

**Lippmann's triangular relationship on the crime scene: Pseudo-environments
convicting the innocent**

Robin Blom, Ball State University

**Public opinion on space exploration: a permanent piece on the medium-sized
American Heart**

Aida Ramusovic, University of Cincinnati; Nancy Jennings, University of
Cincinnati

Public Opinion in an Era of Great Power Decline

Jonathan Schulman, Northwestern University

Examining partisanship and hypocrisy in satirical climate messaging: Mirth and Hope Boost Efficacy

Alexandra Frank, University of Georgia

Affect Embedded within Images: Visual Framing Effects in Reports of Social Movements

Yibing Sun, University of Wisconsin-Madison; Jiwon Kang, University of Wisconsin-Madison

Cross Cultural Perspectives in Public Opinion Research

Lincoln Park

Moderator: Matthew Courser

Euroscepticism: Underconsidered issues in measurement

Eftichia Teperoglou, Aristotle University of Thessaloniki; Emmanouil Tsatsanis, University of Athens; Alexandros- Christos Gotinakos, Aristotle University of Thessaloniki

Framing Refugees: A Cross-National Survey Experiment

Isabel Skinner, University of Illinois Springfield; Timothy B. Gravelle, Wilfrid Laurier University

Slava Ukraini!: Ukrainian Perspectives on the Russian Invasion and the Future of Ukraine

Claire Krummenacher, NORC at the University of Chicago; Haley Broughton, NORC at the University of Chicago; Juan Carlos Donoso, NORC at the University of Chicago; Vadim Volos, NORC at the University of Chicago; Jennifer Benz, NORC at the University of Chicago

Do Chinese Oppose Government Policies to Different Degrees among Generations?

Minju Yeo

A Tale of Two Surveys: Comparing Survey Data Collection Efforts in a Developing Country

Oluseyi Adegbola, DePaul University; Sherice Gearhart, Texas Tech University

Sample Sources and Data Quality

Rivernorth A

Moderator: Nicolas Rodriguez

Please Repeat: Comparing Analytic Models Across Samples and Modes

Larry Osborn, Ipsos; Madeline Gosz, Ipsos; Randall K. Thomas, Ipsos; Frances M. Barlas, Ipsos; Poom Nukulkiij, Ipsos

Validating the Representativeness of Online Non-probability Samples

Sandhya Nori, Civis Analytics

A Comparison of Data Quality in Probability and non-Probability Panels

Jenny Marlar, Gallup; Elynn Maese, Gallup; Emily Lorenz, Gallup; Luke Natzke, Gallup

Evaluating difference Between Online Non-Probability Samples

Kyle Endres, Center for Social and Behavioral Research, University of Iowa

Comparing Amazon's MTurk & a Sona Student Sample: A Test of Data Quality Using Attention & Manipulation Checks

Yani Zhao, Texas Tech University; Sherice Gearhart, Texas Tech University;

Break and Refreshments	Outside DePaul	Friday, 2:45 PM – 3:15 PM
-------------------------------	-----------------------	----------------------------------

Networking Coffee Session

Enjoy freshly brewed coffee, tea, and water, as well as tasty desserts. Students and career professionals who signed up for the networking coffee session will use this time to meet up and chat. Feel free to take your refreshments with you!

Annual Address	Rivernorth BCD	Friday, 3:15 PM – 4:45 PM
-----------------------	-----------------------	----------------------------------

Sponsored by MAPOR's 2022 Gold Sponsors: EdChoice, Ipsos Public Affairs, Marketing Systems Group, and NORC at the University of Chicago

Presentation of Awards and New MAPOR Fellow Announced

Keynote Address: "The Public Interest in Public Polling"

Charles Franklin

Marquette University

President's Reception	Atrium South	Friday, 4:45 PM – 6:00 PM
------------------------------	---------------------	----------------------------------

Join us for complimentary drinks and appetizers and celebrate MAPOR's 47th birthday! The poster session will be going on and you can meet some of our sponsors in person.

Student Conference Registration Raffle	Atrium South	Friday, 5:30 PM
---	---------------------	------------------------

MAPOR's student members are automatically entered into a raffle for free registration for next year's MAPOR conference!

Poster Session	Atrium South	Friday, 5:30 PM
-----------------------	---------------------	------------------------

- 1. Differentiated News Framing of Climate Change Issues in the U.S. and China**
Won Yong Jang, University of Wisconsin at Eau Claire; Edward Frederick, University of Wisconsin at Whitewater
- 2. Linking Survey and Social Media Data: Correlates of Consent to Data Linkage and Potential Biases**

Deji Suolang, University of Michigan

3. Do We Need a Survey Typology for the Modern Survey Landscape?

Abbey Hammell, University of Minnesota; Kenneth Wallen, University of Idaho; Katherine Dentzman, Iowa State University; Donald Dillman, Washington State University

4. “Hello, I am calling for...”: An Experimental Test of Study Sponsorship on Survey Participation

Alyssa McCoy, Center for Social & Behavioral Research, University of Northern Iowa; Rod Muilenburg, Center for Social & Behavioral Research, University of Northern Iowa; Eliza Daly, Iowa Department of Health and Human Services; Olivia Diggs, Iowa Department of Health and Human Services

5. Vaccine Hesitancy in Hispanic/Latine Students in Miami Age 18+

Cristina Orozco, University of Chicago; Robert Vargas, University of Chicago

6. Ready or not here it (NPP) comes: Variations in responses by type of questions, mode and sample type

Ki Park, University of Northern Iowa; Kyle Endres, Center for Social & Behavioral Research, University of Northern Iowa; Justine Radunzel, Center for Social & Behavioral Research, University of Northern Iowa; Erin Heiden, Center for Social & Behavioral Research, University of Northern Iowa; Mary Losch, Center for Social & Behavioral Research, University of Northern Iowa

DETAILED SCHEDULE | SATURDAY NOVEMBER 19, 2021

Refreshments	Outside DePaul	Saturday, 8:00 AM – 10:00 AM
---------------------	-----------------------	-------------------------------------

Enjoy refreshments to start the morning.

Paper Session 3	Saturday, 8:30 AM – 10:00 AM
------------------------	-------------------------------------

Exploring Political Ideology and Polarized Public Opinion **DePaul**

Moderator: Martha Van Haitsma

Finding ideological constraint: Narrow pockets instead of wide ranges
Jeremy Levy, Northwestern University

Party ID Revisited: Interpreting Party ID Construction in Political Polling During the Era of Polarization

Ryan C. Tully, Ipsos; Randall K. Thomas, Ipsos; Frances Barlas, Ipsos

“Fools, Tools, and Idiots”: Moral Conviction and Animosity toward Those who Disagree

Robin Bayes, Northwestern University

Examining the salience and impact of affective polarization on negative American political behavior

Erik J. Brooks, University of North Carolina

When Evaluating News Media Becomes Part of Partisan Loathing: Assessing American Public’s Normative Beliefs and Descriptive Evaluations

Xinle Jia, The University of Wisconsin-Madison; Zhongdang Pan, The University of Wisconsin-Madison; Fangjing Tu, The University of Wisconsin-Madison

Survey Mode Effects on Data Quality

Lakeview

Moderator: Jolene Smyth

ADVANCED CELLULAR RDD – THE NEXT GENERATION

Mansour Fahimi, Marketing Systems Group

Maintaining Trends in the Face of Changes in Mode and Other Measurement Disruptions

Tom W. Smith, NORC at the University of Chicago

The effect of survey mode on the report of sensitive attitudes or beliefs of marijuana: results from a randomized controlled school-based study in the US

Nicolas Rodriguez, University of Michigan; Richard A. Miech, University of Michigan

If you can't say something nice, don't say anything at all: Variations in disclosing undesirable behaviors by mode and sample type.

Kyle Endres, Center for Social and Behavioral Research, University of Iowa; Ki Park, Center for Social and Behavioral Research, University of Iowa; Erin Heiden, Center for Social and Behavioral Research, University of Iowa; Eva Aizpurua, Meta; Mary Losch, Center for Social and Behavioral Research, University of Iowa

Follow for More: Social Media and Public Opinion Research

Lincoln Park

***Moderator:* Brittany Creel**

Social Identity Motivation for Social Media Use and Political Consumerism

Jiwon Kang, University of Wisconsin-Madison

Could I Interest You in Everything All of the Time? An Exploration of Gen Z, Technology, and Media

Betsy Broaddus, NORC at the University of Chicago; David Sterrett, NORC at the University of Chicago; Dan Malato, NORC at the University of Chicago; Jennifer Benz, NORC at the University of Chicago; Trevor Tompson, NORC at the University of Chicago

The Power of Social Media Influencers: A Study of Public Perception of Credibility

Fatima Al salem, Kuwait University

Streaming Live: An Illustration of Public Opinion Research using Twitch.tv

Angelica Phillips, University of Nebraska-Lincoln, NORC at the University of Chicago; M. Jailene Aguirre, University of Illinois, Urbana-Champaign, NORC at the University of Chicago; Marissa C. Ashner, University of North Carolina at Chapel Hill, NORC at the University of Chicago; Angel Bohannon, Northwestern University, NORC at the University of Chicago; Antonia E. Caba, University of Connecticut, NORC at the University of Chicago

Tracking Census Online Self-Completion using Twitter Posts

Mao Li, University of Michigan

Paper Session 4

Saturday, 10:15 AM – 11:45 AM

Exploring Public Opinion on Social, Economic, and Political Issues

DePaul

***Moderator:* Evgenia Kapousouz**

Factors influencing U.S. public opinion of suicide over 40 years

Julie L. Andsager, University of Tennessee

The Role of Military Service on Approval of US Institutions

Jennifer Lin, Northwestern University

Interest in Participating in Participatory Budgeting and Local Funding Priorities

David Doherty, Loyola University; Raluca Pavel, Loyola University; Maddie Jackson, Loyola University

Take Me Home, Country Roads: Differences between Self-Reported Urbanicity & Empirical Measures

Ridgley Knapp, NORC at the University of Chicago; Nick Leberer, NORC at the University of Chicago; David Sterrett, NORC at the University of Chicago

Linking Perceptions about the Role of Federal and State Government and the Support for Texas and Mississippi Laws in the US

Beyza Ekin Buyuker, Indiana University - Bloomington; Kristen N. Jozkowski, Indiana University - Bloomington; Brandon L. Crawford, Indiana University - Bloomington; Ronna Turner, University of Arkansas; Wen-Juo Lo, University of Arkansas

The Longest War: Examining Public Opinion Towards The War In Afghanistan

Ryan Tully, Ipsos; Randall Thomas; Ipsos

Innovations in Contact Materials for Improving Data Quality

Lakeview

Moderator: Chuck Shuttles

Household Screening on the Web: Participation outcomes based on experimental milestone incentives on the General Social Survey

Beth Fisher, NORC at the University of Chicago; Walter Hanley, NORC at the University of Chicago; Jodie Smylie, NORC at the University of Chicago

A Typology for Classifying On-Screen Interviewer Instructions and Definitions

Mark Nathin, University of Michigan

Visible cash, a second incentive, and Priority Mail? An experiment in a national web/mail survey

Shiyu Zhang, University of Michigan; Brady T. West, University of Michigan; James Wagner, University of Michigan; Mick P. Couper, University of Michigan; Rebecca Gatward, University of Michigan

A Tailored Mailing Experiment for Recruiting U.S. Veterans in Survey Research

Vince Welch, NORC at the University of Chicago; Erin Fordyce, NORC at the University of Chicago; Claire Hoffmire, U.S. Department of Veterans Affairs; Evan Herring-Nathan, NORC at the University of Chicago; Lindsey L. Monteith, U.S. Department of Veterans Affairs

Remember, you can complete this survey online! Adding a web survey URL to the mail survey cover

Amanda Ganshert, University of Nebraska-Lincoln; Kristen Olson, University of Nebraska-Lincoln

Exploring Race and Gender in the Context of Public Opinion Research

Lincoln Park

Moderator: Hillary Hanson

Fifty years of Title IX: Exploring Americans' attitudes toward gender equality
Semilla Stripp, NORC; Haley Broughton, NORC; David Sterret, NORC

Measurement Error in Gender Identity: Implications for Estimated Association of Gender & Mental Health
Robert Schultz, University of Michigan

Heterogeneity among Asian-Americans: Implications for Response Styles
Allyson Holbrook, University of Illinois Chicago; Timothy P. Johnson, University of Illinois Chicago; Evgenia Kapousouz, University of Illinois Chicago; Young Ik Cho, University of Wisconsin Milwaukee

Context and Coping: Exploring the Relationship Between Exposure to Environmental Risk and Stress Among Ethnoracial Groups in Greater Chicago.
Juanita Vivas Bastidas, Loyola University; Maria Akchurin, Loyola University; Dana Garbarski, Loyola University; David Doherty, Loyola University

Lesbian Descriptive Representation
Caroline Pippert, Northwestern University; Maya Novak-Herzog, Northwestern University

Speed Networking

Rivernorth A

Moderator: Justine Bulgar-Medina

Lunch **Saturday, 11:45 AM – 1:15 PM**

On your own

Pedagogy Hour **Rivernorth BCD** **Saturday, 1:30 PM – 2:30 PM**

Sponsored by MAPOR's 2022 Gold Sponsors: EdChoice, Ipsos Public Affairs, Marketing Systems Group, and NORC at the University of Chicago

“Mental & Substance Use Disorder Prevalence Study: Using Probability & Nonprobability Sample Data to Enhance Coverage of the U.S. Adult Population”

Jill Dever
RTI International

Break and Refreshments **Outside DePaul** **Saturday, 2:30 PM – 2:45 PM**

Enjoy freshly brewed coffee, tea, and water, as well as tasty desserts.
DePaul is open to begin to gather and reflect about MAPOR members lost this year.

Paper Session 5 **Saturday, 2:45 PM – 4:15 PM**

Open for in memoriam

DePaul

For those who continue to gather and reflect about MAPOR members lost this year.

Advancement in Data Collection Methods for Improving Data Quality

Lakeview

Moderator: Erin Heiden

Respondent Burden and Data Quality of Dependent Interviewing within a Self-Administered mode

Curtiss Engstrom, University of Michigan; Jennifer Sinibaldi, Penn State University

Geographic Data Collection and Field Team Location Validation within Enumeration Areas: An Application in Areas Without Address Frames

Andrea Malpica, NORC at the University of Chicago; Brian Kirchoff, NORC at the University of Chicago

A Community-driven Survey Approach to Understanding Stigma: Methodology and Implications

Matthew Courser, Pacific Institute of Research and Evaluation; Holly Raffle, Ohio University; Stephen R. Shamblen, Pacific Institute for Research and Evaluation; April Schweinhart, Pacific Institute for Research and Evaluation

Measuring Air Quality with Wearable Devices

Htay-Wah Saw, University of Michigan; Arie Kapteyn, University of Southern California; Bas Weerman, University of Southern California

Understanding Respondent Characteristics from the 2022 GSS Follow-on Studies: Why it Matters

Benjamin Schapiro, NORC at the University of Chicago; Rene Bautista, NORC at the University of Chicago; Jodie Smylie, NORC at the University of Chicago; Deanna Christianson, NORC at the University of Chicago;

Evaluating Effects of Question Format on Survey Responses

Lincoln Park

Moderator: Jerry Timbrook

Investigating How Different Item Formats Can Meet Different Reliability Needs in Attitude Measurement

Ronna C. Turner, University of Arkansas; Xixi Wang, University of Arkansas; Wenjuo Lo, University of Arkansas; Brandon L. Crawford, Indiana University; Kristen N. Jozkowski, Indiana University

Agree to Disagree?: Response Patterns in Agreement vs. Item-Specific Formats

Megan A. Hendrich, Ipsos; Randall K. Thomas, Ipsos

Comparing Binary and 4- and 6-point Likert Scales Formats

Wen-Juo Lo, University of Arkansas; Nana Amma Asamoah, University of Arkansas; Xixi Wang, University of Arkansas; Ronna Turner, University of Arkansas; Brandon Crawford, Indiana University; Kristen Jozkowski, Indiana University

Evaluating the Effect of Response Scale Format: Evidence from an Experiment in Multi-Device Web Surveys

Oscar Castorena, LAPOP Lab at Vanderbilt University

Evaluating the Effectiveness of Visual Analog Scales to Measure Expectations

Z. Tuba Suzer-Gurtekin, University of Michigan; Zhen Sun, University of Michigan; Rachel Moloney, University of Michigan

Sampling Techniques and Data Quality

Rivernorth A

Moderator: Kelly Elver

Item Nonresponse in the GSS: Demographic Differentials within Geographical Contexts

Rachel Sparkman, NORC at the University of Chicago; Jodie Smylie, NORC at the University of Chicago; Rene Bautista, NORC at the University of Chicago

Can One Weight Fit All? Adjusting Hybrid Samples for Subgroup Estimation

Michael T. Jackson, SSRS

Innovations in Hybrid Sampling - Improving Representation of Teens and Young And Young Adults

Mansour Fahimi, Marketing Systems Group

Data Fusion for Enhanced Survey Sampling Applications

Mansour Fahimi, Marketing Systems Group

Targeting Accuracy?: Does Targeted Sample Reduce Bias in Probability-based Samples?

Randall K. Thomas, Ipsos; Megan A. Hendrich, Ipsos

Annual Member Meeting

Lakeview

Saturday, 4:30 PM – 5:30 PM

MAPOR President Kevin Ulrich will lead the annual member and business meeting.

MAPOR Fellows

1988 Doris Graber
1989 George Donahue, Clarice Olien &
Phillip Tichenor
1990 Jack McLeod
1992 Donna Charron
1993 David H. Weaver
1994 George Bishop
1996 Lee Becker
1997 Paul J. Lavrakas
1998 Leo Jeffres
1999 Mark Miller
2000 Cecilie Gaziano
2002 Michael Traugott
2003 Richard M. Perloff
2004 Robert P. Daves
2005 Sharon Dunwoody
2006 K. "Vish" Viswanath
2007 Allan L. McCutcheon
2008 Robert M. Groves
2010 Albert Gunther
2011 Stephen E. Everett
2012 Peter V. Miller
2013 Patricia Moy
2014 Tim Johnson
2015 Nora Cate Schaeffer
2016 Julie Andsager and Joe Murphy
2017 John Stevenson
2018 John Loft
2019 Tom Smith
2020 Ronald Langley
2021 Allyson Holbrook

MAPOR Presidents

1976-77 Donna S. Charron
1977-78 George Bishop
1978-79 Gene Telser
1980-81 Doris Graber
1981-82 Andrew J. Morrison
1982-83 MariJean Suelzle
1983-84 Lee B. Becker
1984-85 Barbara A. Bardes
1985-86 D. Charles Whitney
1986-87 David H. Weaver
1987-88 Leo Jeffres
1988-89 Cecilie Gaziano
1989-90 Sharon Dunwoody
1990-91 M. Mark Miller
1991-92 Garrett O'Keefe
1992-93 Robert P. Daves
1993-94 Paul J. Lavrakas
1994-95 Richard M. Perloff
1995-96 William Elliott
1996-97 Ellen M. Dran
1997-98 Fiona Chew
1998-99 Sherry Marcy
1999-00 Stephen E. Everett
2000-01 William Rosenberg
2001-02 K. "Vish" Viswanath
2002-03 Julie Andsager
2003-04 Allan L. McCutcheon
2004-05 Douglas Blanks Hindman
2005-06 Dietram A. Scheufele
2006-07 David Tewksbury
2007-08 Ward Kay
2008-09 Patricia Moy
2009-10 Weiwu Zhang
2010-11 Timothy P. Johnson
2011-12 Michael Traugott
2012-13 Joe Murphy
2013-14 Kristen Olson
2014-15 Allyson Holbrook
2015-16 Trent Buskirk
2016-17 Matthew Courser
2017-18 Ron Langley
2018-19 Ipek Bilgen
2019-20 Ned English
2020-21 Dana Garbarski
2021-22 Kevin Ulrich