

Midwest Association
for Public Opinion Research



49th Annual Conference
Bridging Trends from our Past with
Insights for Tomorrow

Preliminary Program

November 22-23, 2024
Embassy Suites Downtown Chicago
600 N. State Street
Chicago, IL 60654

CONFERENCE AT A GLANCE

FRIDAY, NOVEMBER 22

8:00 AM – 8:30 AM	Atrium South	Early Registration for Short Course
8:00 AM – 10:00 AM	Outside DePaul	Refreshments
8:30 AM – 6:00 PM	Business Center	Sponsor Exhibit
8:30 AM – 10:30 AM	Lincoln Park	Short Course Jennifer Dykema and Nora Cate Schaeffer, University of Wisconsin – Madison “Beyond the Basics: Advanced Questionnaire Design for Writing Questions about Events and Behaviors” (registration required)
8:30 AM – 4:30 PM	Atrium South	General Registration
10:45 AM – 12:15 PM	Lincoln Park	The Intersection of Public Opinion and Location
	DePaul	Public Opinions on Social and Political Issues
	Rivernorth CD	Preparing for the Field: Translations, Cognitive Interviews and Training
12:15 PM – 1:15 PM	Atrium North	Lunch Buffet (ticket required)
1:30 PM – 3:00 PM	Rivernorth CD	Exploring Generative AI for Survey Research
	DePaul	Journalism, Communication and Public Opinion
	Lincoln Park	Data Collection, Mode and Survey Recruitment: Lessons from the Field
3:00 PM – 3:30 PM	Outside DePaul Atrium	Break and Refreshments Networking Coffee Session
3:45 PM – 5:00 PM	Rivernorth	Student Paper & MAPOR Fellow Awards Keynote Speaker Lydia Saad, Gallup “Young Women and Men in the U.S.: A Political Mismatch?”

5:00 PM – 6:00 PM	Business Center	President’s Reception (Complimentary wine, beer, and soft drinks) Poster Session Sponsor Tables Student Conference Registration Raffle
-------------------	-----------------	--

SATURDAY, NOVEMBER 23

8:00 AM – 3:00 PM	Atrium South	General Registration
8:00 AM – 10:00 AM	Outside DePaul	Refreshments
8:30 AM – 10:00 AM	Lincoln Park	Probability-Based Panels: Nonresponse, attrition and data quality
	DePaul	Analyzing Identities and Beliefs in Cross Cultural Contexts
	Rivernorth CD	Issues in Questionnaire Design
10:15 AM–11:45 AM	Lincoln Park	The State of State Panels
	DePaul	Measuring Gender Identity and Race/Ethnicity
	Rivernorth AB	Linking Survey Data and Alternative Data Sources
	Rivernorth CD	Perspectives on Data Quality
12:00 PM – 1:00 PM		Lunch (on your own)
1:15 PM – 2:30 PM	Rivernorth	Pedagogy Hour Trent Buskirk, Old Dominion University “They are Large, but should they be in Charge? Exploring the Possibility and Implausibility of Large Language Models in Survey Science”
2:30 PM – 2:45 PM	Outside DePaul	Break and Refreshments

2:45 PM – 4:15 PM	Room TBD	Open for in memoriam
	Lincoln Park	Strategies for Improving Survey Participation
	DePaul	Innovations in Sampling and Nonresponse
	Rivernorth CD	Considerations for Questions Design and Measurement
4:30 PM – 5:30 PM	Rivernorth CD	Annual Member Meeting

Map of the Embassy Suites

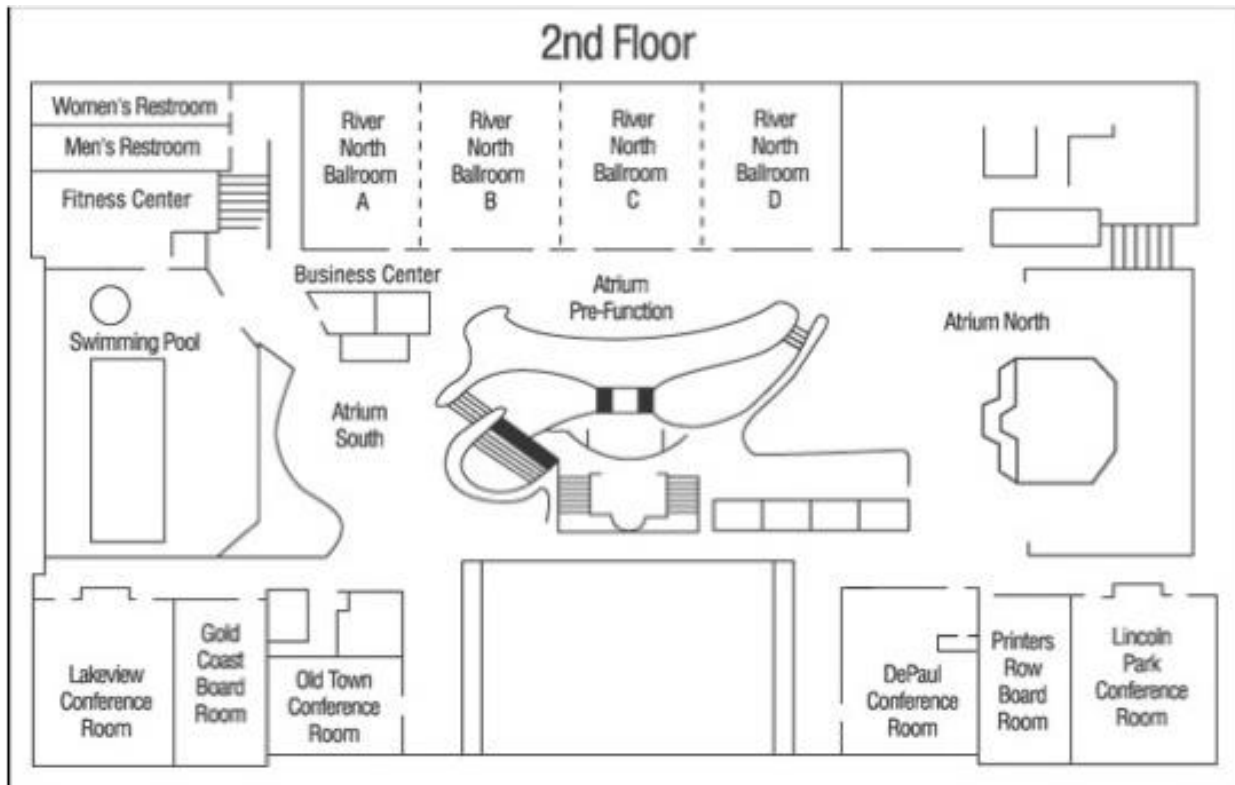

Conference Sponsors

MAPOR acknowledges and thanks the following organizations for sponsoring the 2024 conference. Your support ensures that MAPOR can continue to offer a successful conference each year!

Gold Level Sponsors – TBA – To be a sponsor or for more information about sponsorship, contact BulgarMedina-Justine@NORC.com

Silver Level Sponsors – TBA

Bronze Level Sponsors – TBA

MAPOR Officers

President	Leah Dean, RTI International
Vice-President/President-Elect	Y. Patrick Hsieh, RTI International
Past President	Justine Bulgar-Medina, NORC at the University of Chicago
Conference Chair	Jenny Marlar, Gallup
Associate Conference Chair	Beth Fisher, NORC at the University of Chicago
Secretary-Treasurer	Lindsey Witt-Swanson, NORC at the University of Chicago
Associate Secretary-Treasurer	Semilla Stripp, NORC at the University of Chicago
Member-at-Large	Carlye Arcas, RTI International
Member-at-Large	Paul DiPerna, EdChoice
Member-at-Large	Erin Heiden, University of Northern Iowa
Member-at-Large	Yorkow Oppon-Acquah
Member-at-Large	Rebecca Powell, RTI International
Member-at-Large	Caroline Smith
Member-at-Large	Jerry Timbrook, RTI International
Communications Coordinator	Benjamin Schapiro, NORC at the University of Chicago
Student Liaison	Curtis Engstrom, University of Michigan

DETAILED SCHEDULE | FRIDAY NOVEMBER 22, 2024

Refreshments — Outside DePaul

Friday, 8:00 AM – 10:00 AM

Short Course (registration required)

Friday, 8:30 AM – 10:30 AM

Short Course:

Lincoln Park

Beyond the Basics: Advanced Questionnaire Design for Writing Questions about Events and Behaviors

Instructors:

Jennifer Dykema University of Wisconsin–Madison, MAPOR Fellow

Nora Cate Schaeffer, University of Wisconsin–Madison, MAPOR Fellow

Question writers are confronted with many steps and decisions when writing questions about events (things that happen to the respondent) and behaviors (things the respondent does). In this short course, we use a decision-making framework to demystify the process of writing effective questions about events and behaviors. Drawing on published literature, recent experiments from online surveys, and other sources, participants will learn about evidenced-based guidelines and best practices for writing questions that ask about events and behaviors. Course objectives include:

- Present a decision framework outlining the steps questions writers must address when writing questions about events or behaviors. In addition to highlighting steps, the decision framework introduces important characteristics specific to questions about events and behaviors (e.g., filter questions, reference periods).
- Describe how question writers can use question structure (e.g., instructions, definitions, examples, decomposition) and question order to improve how they label and define events and behaviors.
- Provide recommendations about response formats for questions that measure occurrence (e.g., whether the respondent engaged in a behavior), including how to write effective filter questions.
- Provide recommendations about response formats for questions that ask about absolute and relative frequencies (e.g., “how often” and “how many times” questions).
- Discuss the complex decisions question writers face when writing questions that measure both occurrence and frequency.
- Discuss issues related to grouping questions including check-all versus check-list formats and grouped versus interleaved formats.
- Provide examples illustrating “problematic” and “revised” questions.
- Engage in hands-on practice identifying problematic question characteristics and suggesting improvements.

Whether you’re a survey novice or a seasoned professional, this course will enhance your ability to design questions about events and behaviors that yield precise, actionable data. Equip yourself with the tools and knowledge to elevate your surveys and drive better decision-making.

The Intersection of Public Opinion and Location

Lincoln Park

Moderator: TBD

Political Talk Radio and Rural Conservatism

Heyu Xiong, Case Western Reserve University

The Impact of Residential Arrangement on Wellbeing of Low-Income Migrant Workers in Qatar

Fatimah Alkhalidi, The New School

“Empire State of Mind”: The Influence of State Politics on Individual's Views

Katie Keil, Northwestern University

The Cosmopolitan's Compromise: Responding to Citizen Demands with Migration Policy and Foreign Aid

Kathleen Weaver, Tulane University

Public Opinions on Social and Political Issues

DePaul

Moderator: TBD

Ambivalence of Strong Social Ties: Typology, Prevalence, and Effects on Well-Being

Henning Silber, GESIS - Leibniz Institute for the Social Sciences

Theresia Ell, GESIS - Leibniz Institute for the Social Sciences

Lydia Repke, GESIS - Leibniz Institute for the Social Sciences

General Social Survey Trends in Public Opinion on Book Banning

Makena Rhea Nail, University of Nebraska-Lincoln

Training Citizen Officers: Attitudinal Outcomes of a Military Education

Jennifer Lin, Northwestern University

What Motivate Generation Z to Boycott or Buycott Corporate Social Advocacy (CSA)

Avery Robbins, Loyola University Chicago; Chris Yim, Loyola University Chicago

Preparing for the Field: Translations, Cognitive Interviews and Training Rivernorth CD

Moderator: TBD

Treating Translation as a Scientific Component of Cross-national Research using Quantification and Experiments

Tom W. Smith, NORC at the University of Chicago

Cognitive Testing of SOGI Items for Spanish Speakers in the US

Alisú Schoua-Glusberg, Research Support Services; Daniela Glusberg, Research Support Services; Dave Roe, ICF; Adam Kaderabek, ICF; Jody Herman, The Williams Institute/UCLA School of Law; Shelley Feuer, NCSES(NSF); John Finamore, NCSES(NSF)

Measures of Cognitive Health in a Multilingual Survey Context

Sunghee Lee, University of Michigan; Stephanie Morales, University of Michigan

Measuring Collective Efficacy: Cognitive Interviews with Chicago Residents

Tori Olson; Loyola University Chicago

Cross That Bridge When We Come to It: Training Data Collectors Throughout a Multi-Phase Study

Bethany Vanspronsen, RTI; Samantha Lako, RTI; Lydia Perry, RTI

Lunch Buffet Atrium North Friday, 12:15 PM - 1:15 PM

Make new connections or connect with old friends during our lunch buffet. Tables will be set up throughout the hotel mezzanine so that participants will be able to move around and socialize. The lunch is free for all students, and non-students must register for the event!

Exploring Generative AI for Survey Research

Rivernorth CD

Moderator: TBD

Leveling the Reading Level: An Experimental Prompting Approach for Controlling the Reading Levels of Survey Questions Drafted from Generative AI Tools

Trent Buskirk, Old Dominion University School of Data Science; Adam Eck, Oberlin College Department of Computer Science; Jerry Timbrook, RTI International;

ChatBot Is a Two-Syllable Word...Or Is It? Using ChatGPT for Survey Question Readability Assessments

Kristen Olson, University of Nebraska-Lincoln; Trent Buskirk, Old Dominion University

Using Large Language Models to Code Survey Question Characteristics

Jerry Timbrook, RTI International; Ashley Griggs, RTI International; Peter Baumgartner, RTI International; Kirsty Weitzel, RTI International

Assessing the Accuracy of and Bias with Zero-Shot Text Classification using GPT: A Case Study with Social Media and Survey Data

Haoyu Shi, NORC at the University of Chicago; Simon Page, NORC at the University of Chicago; Joshua Lerner, NORC at the University of Chicago; Hy Tran, NORC at the University of Chicago; Brandon Sepulvado, NORC at the University of Chicago

Journalism, Communication and Public Opinion

DePaul

Moderator: TBD

Divergent News Framing of the North Korean Missile Crisis: A Comparative Analysis of Global News Agencies

Won Jang, University of Wisconsin at Eau Claire

Preferred Information Sources and Their Influence in Shaping Perception of Public Health Authorities in the United States

David Levin, Deloitte Center for Machine Intelligence and Data Science; Alison Muckle, Deloitte Center for Government Insights; Anna Margaret Clyburn, Harvard T.H. Chan School of Public Health; Maria Fionalita, Deloitte Center for Machine Intelligence and Data Science; Joseph Bakal, Deloitte Consulting; Brian Kamoie, Deloitte Consulting

Using Unsupervised K-Means Clustering Algorithm to Identify the Four Types of Public Health Consumers in the United States

Alison Muckle, Deloitte Center for Government Insights; David Levin, Deloitte Center for Machine Intelligence and Data Science; Anna Margaret Clyburn, Harvard T.H. Chan School of Public Health; Maria Fionalita, Deloitte Center for Machine Intelligence and Data Science; Joseph Bakal, Deloitte Consulting; Brian Kamoie, Deloitte Consulting

Do Newsrooms Matter? Comparing Professional Role Perceptions of Full-Time Journalists And Freelancers in the United States

Lars Willnat, Syracuse University; David H. Weaver, Indiana University;

Data Collection, Mode and Survey Recruitment: Lessons from the Field Lincoln Park

Moderator: TBD

A decade of change: Design adaptations and lessons learned in an annual statewide population survey from 2012 to 2023

Erin Heiden, University of Northern Iowa; Ki Park, University of Northern Iowa; Hillary Wehe, University of Northern Iowa; Mary Losch, University of Northern Iowa

Identifying the Mode Effects of the Health Retirement Study 2018 Core Survey Using Structural Equation Modeling

Zhuoyu Wang, University of Michigan, NORC at the University of Chicago;

Substance Use and Wellbeing in Pereira and Dosquebradas, Colombia: Data from Two Household Surveys

Matthew Courser, Pacific Institute for Research and Evaluation--Louisville Center; Stephen R. Shamblen, Pacific Institute for Research and Evaluation--Louisville Center; Marissa Elias, Pacific Institute for Research and Evaluation--Southwest Center; Elika Whitney, Pacific Institute for Research and Evaluation--Louisville Center; Linda Young, Pacific Institute for Research and Evaluation--Louisville Center;

Response Effects by Web vs. Mail Interviews in a General Population Survey

Bozhou Tan, University of Michigan; Z.Tuba, Suzer-Gurtekin, University of Michigan

Plenty of Fish in the Sea: Targeting Hard-to-Reach Populations in the 2022 National Survey of Fishing, Hunting, and Wildlife-Associated Recreation

Semilla Stripp, NORC; Lindsey Witt-Swanson, NORC; David Sterrett, NORC; Emily Alvarez, NORC

Break and Refreshments	Outside DePaul	Friday, 3:00 PM – 3:30 PM
-------------------------------	-----------------------	----------------------------------

Networking Coffee Session

Enjoy freshly brewed coffee, tea, and water, as well as tasty desserts. Students and career professionals who signed up for the networking coffee session will use this time to meet up and chat. Feel free to take your refreshments with you!

Annual Address	Rivernorth	Friday, 3:45 PM – 5:00 PM
-----------------------	-------------------	----------------------------------

Presentation of Awards and New MAPOR Fellow Announced

Keynote Address:

“Young Women and Men in the U.S.: A Political Mismatch?”

Lydia Saad, Gallup, Director of U.S. Social Research

President’s Reception	Business Center	Friday, 5:00 PM – 6:00 PM
------------------------------	------------------------	----------------------------------

Join us for complimentary drinks and appetizers.

The poster session will be going on, and you can meet some of our sponsors in person.

Poster Session	Atrium South	Friday, 5:10 PM
-----------------------	---------------------	------------------------

- 1. My left, your right? A methodological study of ideological self and party positioning on political ideology scales**
Alexandros-Christos Gkotlinakos, Aristotle University of Thessaloniki
- 2. Exploring the internal categories of Question Understanding Aid (QUAID): A case study of 2016 GSS questions.**
Isaac Tagoe, University of Wisconsin-Madison; Nora Cate Schaeffer, University of Wisconsin-Madison; Jennifer Dykema, University of Wisconsin-Madison; Dana Garbarski, Loyola University-Chicago
- 3. Film Genre Taste Publics: Audiences, Creators, Influences**
Leo Wayne Jeffres, Cleveland State University; Kimberly Neuendorf, Cleveland State University; David Atkin, University of Connecticut
- 4. Examining the Adverse Childhood Experiences, Condom Use and Sexual Intercourse Among College Students**
Kruti S. Chaliawala, University of Cincinnati; Rebecca A. Vidourek, University of Cincinnati; Keith A. King, University of Cincinnati;
- 5. Unleashing AI in Survey Research: Evaluating the Power and Pitfalls of Large Language Models in Evaluating Survey Questions**
Shengfu Wang, National Taiwan University; Jennifer Dykema, University of Wisconsin-Madison; Nora Cate Schaeffer, University of Wisconsin-Madison; Dana Garbarski, Loyola University Chicago

MAPOR’s student members are automatically entered into a raffle for free registration for next year’s MAPOR conference!

DETAILED SCHEDULE | SATURDAY NOVEMBER 23, 2024

Enjoy refreshments to start the morning.

Probability-Based Panels: Nonresponse, attrition and data quality Lincoln Park

Moderator: TBD

Analyzing the causal effect of survey burden on nonresponse and attrition among fresh panel respondents in their first year of membership

Marco Angrisani, University of Southern California (USC); Arie Kapteyn, University of Southern California (USC); Htay-Wah Saw, University of Michigan, Ann Arbor,

Examination of Mode and Device Preference Trends Over Time in a Probability-Based Research Panel

Ipek Bilgen, NORC at the University of Chicago; Erika Archie, NORC at the University of Chicago; Susan Clapp, NORC at the University of Chicago;

Assessing the Efficacy of SMS Survey Recruitment Methods on Members of a Probability-Based Panel

Emilio Rivera, Gallup; Jenny Marlar, Gallup; Jon Schreiner, Gallup

What can probability panels tell us about nonresponse bias in 2024 election polls?

Michael Jackson, SSRS

Evaluating the Impact of Three Incentive Schemes on Survey Nonresponse and Attrition in Online Longitudinal Panels

Htay-Wah Saw, University of Michigan, Ann Arbor; Brady T. West, University of Michigan, Ann Arbor

Moderator: TBD

Exploring Latino Acculturation Through Non-Parametric Cluster Analysis

Jessala Grijalva, University of Notre Dame

“AfD: Achtung für Demokratie?” The Relationship between Extremist Ideologies and Polarized Constituencies in the Federal Republic of Germany

Katie Keil, Northwestern University

Challenging the Authoritarian Theory of the Press: Mostafa Amin and Press Freedom under King Farouk’s Rule in Egypt

Hadi Eltahlawi, University of Nevada, Reno

Revisiting the Meritocracy Paradox: The Role of Intergenerational Mobility from Bayesian Multilevel Perspectives

Siyun Gan, University of Wisconsin – Madison

Defining Taiwan: The Relationship Between Media Terminology and Public Opinion

Ben Alperstein, University of Chicago

Issues in Questionnaire Design

Rivernorth CD

Moderator: TBD

Studying interviewer-respondent interactions in attitudinal questions with item-specific scales vs. agree/disagree scales

P. Linh Nguyen, University of Essex, University of Mannheim; Yfke Ongena, University of Groningen; Timothy Johnson, University of Illinois at Chicago

Measuring the Occurrence and Frequency of Self-Reported Behaviors: Joint Effects of Filter Questions and Response Format on Estimates

Isaac Tagoe, University of Wisconsin-Madison; Jennifer Dykema, University of Wisconsin-Madison; Nora Cate Schaeffer, University of Wisconsin-Madison; Nadia Assad, University of Wisconsin-Madison

Your Survey is how Long? Evaluating the Feasibility of a Split-Questionnaire Design to Reduce Respondent Burden in the California Health Interview Survey

Cordelia Horch, SSRS; Cameron McPhee, SSRS; YuChing Yang, UCLA; Jiangzhou Fu, UCLA

Adjusting the ANES Module in the 2024 General Social Survey Post-President Biden Withdrawing from the Race

Olivia Hanley, NORC; Abigail Norling-Ruggles, NORC; Andrew Stern, NORC; Rachel Sparkman, NORC

The State of State Panels: Insights in Creating and Maintaining State- and Regional-Level Survey Panels in Five States

Lincoln Park

Moderator: Kristen Olson

Opportunity, Engagement, Partnership: Lessons Learned Launching the Rutgers-Eagleton/SSRS Garden State Panel

Ashley Koning, Rutgers; Kristen Purcell, SSRS; Kyle Berta, SSRS

Lessons in Setting up the SPACE City Panel in the Houston MSA

Gail J. Buttorff, Pablo M. Pinto, Sunny Wong, Agustín Valleo, Maria Paula Perez, Savannah Sipole: Center for Public Policy, Hobby School of Public Affairs, University of Houston

Should I Stay or Should I Go: Who Joins and Who Participates in a State-based Probability Panel in Wisconsin

Nadia Assad and Jennifer Dykema: University of Wisconsin Survey Center

Ahead of the Curve: Lessons from UNH's Shift to Online Panels

Zach Azem, Tracy Keirns, Sean McKinley, Andrew Smith: University of New Hampshire

An Overview of Nebraska Voices: Recruitment, Retention, and Representativeness

Amanda Ganshert, Kristen Olson: Bureau of Sociological Research, University of Nebraska-Lincoln

Measuring Gender Identity and Race/Ethnicity

DePaul

Moderator: TBD

Predicting the Unobserved: Improving Sexual Identity Measures in Health Disparity Studies with Machine Learning and Resampling

Rona Fang-Yu Hu, Institute for Social Research, University of Michigan; Brady T. West

Improving Measurement of Gender Expression in Surveys: Effects of Question Order and Scale Order on Measurement and Data Quality

Dana Garbarski, Loyola University Chicago; Jennifer Dykema, University of Wisconsin-Madison; Nadia Assad, University of Wisconsin-Madison; Cameron Jones, University of Wisconsin-Madison;

A Comparison of Collapsing and Bridging Methods for Measures of Sexual Identity Using Two National Health Surveys in the United States

Curtiss W. Engstrom, University of Michigan; Brady T. West, University of Michigan; Sean Esteban McCabe, University of Michigan;

Evaluating the Impact of Updated OMB Standards on Race and Ethnicity Data Collection: Insights from a Gallup Panel Experiment

Jenny Marlar, Gallup; Jon Schreiner, Gallup; Ellyn Maese, Gallup

Linking Survey Data and Alternative Data Sources

Rivernorth AB

Moderator: TBD

Assessing the Use of Eligibility Models to Correct for Overcoverage in State Voter Files

Jessica Stapleton, SSRS; Michael Jackson, SSRS

Operationalizing the intersectionality of access to internet and computers

Della Cox, University of Chicago, US Census Bureau;

Leveraging the Demographic Frame for Residential Location

Deliverance Bougie, US Census Bureau

“You exist in the context”: Local news deserts and their impact on election information consumption

Betsy Broaddus, NORC at the University of Chicago; David Sterrett, NORC at the University of Chicago; Mariana Meza Hernandez, NORC at the University of Chicago; Michael Bolden, American Press Institute; Kevin Loker, American Press Institute

Measuring Public Opinion on 2020 Presidential Candidates: the Differences between Social Media and Survey Data

Huaman Sun, University of Toronto

Perspectives on Data Quality

Rivernorth CD

Moderator: TBD

Developing a Data Cleaning Protocol for Survey Research of Hard-to-Reach Populations: Addressing Bots and Fraudulent Responses in the Digital Era

Mikaela Lies, Sinai Chicago: Sinai Urban Health Institute; Esperanza Garcia, Sinai Chicago: Sinai Urban Health Institute; Michaela Krogen, Sinai Chicago: Sinai Urban Health Institute; Melissa Gutierrez-Kapheim, Sinai Chicago: Sinai Urban Health Institute

Bots and Bad Actors: Case Studies for Maintaining Quality Samples Amid Advancing Technologies

Bailee Blankemeier, Gallup

The Effect of Displaying Word Counts on Response Quality for Web Surveys

Hillary Wehe, The University of Northern Iowa; The Kyle Endres, University of Northern Iowa; Steven Jokinsky, The University of Northern Iowa

Optimizing Survey Question Wording: Comparing Respondent Recall for “Last” versus “Past” Reference Periods

Jeremyah Williams, University of Wisconsin-Madison; Jennifer Dykema, University of Wisconsin-Madison; Nadia Assad, University of Wisconsin-Madison; Nora Cate Schaeffer, University of Wisconsin-Madison

Lunch

Saturday, 12:00 PM – 1:00 PM

On your own

Pedagogy Hour

Rivernorth

Saturday, 1:15 PM – 2:30 PM

**Trent Buskirk, Professor and Data Science Fellow
Old Dominion University**

“They are Large, but should they be in Charge? Exploring the Possibility and Implausibility of Large Language Models in Survey Science”

Take a glance through recent news or social media and you would be hard-pressed not to see mentions of chatbots and artificial intelligence (AI) methods aimed at generating text, images and other content. Recent work by Eloundou and colleagues (2023) explored the potential impact of these types of generative AI on labor markets, and survey research was among the top two most impacted industries. In light of this finding, naturally, we wonder: how will this tech change the work in our field? How might chatbot technologies or related software be leveraged to support, enhance, or expand our work by assisting with developing and testing of survey research products such as questions, questionnaires, and study/sampling designs. And even still, how might survey science contribute to the improvement of large language models (LLMs)? In this talk we will describe how LLMs work and showcase some of the current ways that these models are being used within the survey research process chronicling their applications in the design, collection, and analyses of survey data. We will also discuss some limitations of this technology as it relates to applications within the survey research process. We will also pose some relevant ideas around how survey research can also contribute to the development and refinement of large language models. And we note that no part of this abstract was generated using a chatbot.

Break and Refreshments

Outside DePaul

Saturday, 2:30 PM – 2:45 PM

Enjoy freshly brewed coffee, tea, and water, as well as tasty snacks.

Open for in memoriam

ROOM TBD

For those who would like to gather and reflect about MAPOR members lost this year.

Strategies for Improving Survey Participation

Lincoln Park

Moderator: TBD

Email subject line variations on web survey response rates

Jennifer M. Dinh, HealthPartners Institute; Jeanette Y. Ziegenfuss, HealthPartners Institute; Heather Weniger, HealthPartners Institute; Erin Ghery, HealthPartners Institute; Stephanie Hooker, HealthPartners Institute;

Boosting Farmer Survey Response Rates: The Impact of a Second Incentive in a Web-Mail Mixed-Mode Survey

Jaime Faus, University of Wisconsin-Madison; Jennifer Dykema, University of Wisconsin-Madison; Marissa Eckrote-Nordland, University of Wisconsin-La Crosse; Nadia Assad, University of Wisconsin-Madison; J. Michael Collins, University of Wisconsin-Madison; Mai Tah Lee, University of Wisconsin-Madison

Monetary Incentives in Clinician Surveys: An Analyses and Review with a Focus on Establishing Best Practices

Jonathan VanGeest, Kent State University; Timothy Johnson, University of Illinois at Chicago and NORC at the University of Chicago; Evgenia Kapousouz, NORC at the University of Chicago;

Increasing survey participation among difficult cases: Experimenting with “Endgame” offer in the 2022 Health and Retirement Study.

Sergio Martinez, University of Michigan; Heather M. Schroeder, University of Michigan; Brady T. West, University of Michigan

How Low Can We Go: Optimal Post Incentives in Era of Rising Cost and Declining Response Rates

Robyn Rapoport, SSRS; Elizabeth Sciupac, SSRS; Rob Manley, SSRS; Paula Armendariz, SSRS; Cameron McPhee, SSRS

Moderator: TBD

Algorithmic Fairness of Machine Learning Models for Sample Designs in Survey Research

Solvejg Wastvedt, NORC; Patrick Coyle, NORC; Joshua Lerner, NORC; David Dutwin, NORC

Developing Best Practices for Using Small Area Estimation (SAE) for Diversity, Racial Equity, and Inequality (DREI) Research

Carissa Villanueva, NORC; Carolina Franco, NORC at the University of Chicago; Angelo Cozzubo, NORC at the University of Chicago, University of Maryland; Taylor Wing, NORC at the University of Chicago

Model-based or hot deck? Imputing item non-response data in the Survey of Income and Program Participation (SIPP)

Besufekad Alemu, US Census Bureau; Angelica Phillips, US Census Bureau; Ruth E. Sarafin, US Census Bureau; Joey Marshall, US Census Bureau; Sandy Dietrich US Census Bureau

Modeling ABS Survey Response Rates with Measures from the Census Planning Database

Patrick Coyle, NORC

Considerations for Questions Design and Measurement

Rivernorth CD

Moderator: TBD

Below the surface: A closer look at respondent burden and perceived difficulty

Erin Heiden, University of Northern Iowa; Eva Aizpurua, National Centre for Social Research; Ki Park, University of Northern Iowa

Political Disillusionment, Sampling Selection, and Response Satisficing Insights from the Collaborative Midterm Survey

Alexandros-Christos Gkotlinakos, Aristotle University of Thessaloniki; Curtiss W Engstrom, University of Michigan - Ann Arbor

Examining Acquiescent Response Trajectories Among Diverse Populations: Evidence from the Health and Retirement Study

Stephanie Morales, University of Michigan; Sunghee Lee, University of Michigan

Maintaining Data Quality amid Measurement Disruptions

Tom W. Smith, NORC at the University of Chicago

MAPOR President Leah Dean will lead the annual member and business meeting.

MAPOR Fellows

1988 Doris Graber
1989 George Donahue, Clarice Olien &
Phillip Tichenor
1990 Jack McLeod
1992 Donna Charron
1993 David H. Weaver
1994 George Bishop
1996 Lee Becker
1997 Paul J. Lavrakas
1998 Leo Jeffres
1999 Mark Miller
2000 Cecilie Gaziano
2002 Michael Traugott
2003 Richard M. Perloff
2004 Robert P. Daves
2005 Sharon Dunwoody
2006 K. "Vish" Viswanath
2007 Allan L. McCutcheon
2008 Robert M. Groves
2010 Albert Gunther
2011 Stephen E. Everett
2012 Peter V. Miller
2013 Patricia Moy
2014 Tim Johnson
2015 Nora Cate Schaeffer
2016 Julie Andsager and Joe Murphy
2017 John Stevenson
2018 John Loft
2019 Tom Smith
2020 Ronald Langley
2021 Allyson Holbrook
2022 Jennifer Dykema
2023 Kristen Olson

MAPOR Presidents

1976-77 Donna S. Charron
1977-78 George Bishop
1978-79 Gene Telser
1980-81 Doris Graber
1981-82 Andrew J. Morrison
1982-83 MariJean Suelzle
1983-84 Lee B. Becker
1984-85 Barbara A. Bardes
1985-86 D. Charles Whitney
1986-87 David H. Weaver
1987-88 Leo Jeffres
1988-89 Cecilie Gaziano
1989-90 Sharon Dunwoody
1990-91 M. Mark Miller
1991-92 Garrett O'Keefe
1992-93 Robert P. Daves
1993-94 Paul J. Lavrakas
1994-95 Richard M. Perloff
1995-96 William Elliott
1996-97 Ellen M. Dran
1997-98 Fiona Chew
1998-99 Sherry Marcy
1999-00 Stephen E. Everett
2000-01 William Rosenberg
2001-02 K. "Vish" Viswanath
2002-03 Julie Andsager
2003-04 Allan L. McCutcheon
2004-05 Douglas Blanks Hindman
2005-06 Dietram A. Scheufele
2006-07 David Tewksbury
2007-08 Ward Kay
2008-09 Patricia Moy
2009-10 Weiwu Zhang
2010-11 Timothy P. Johnson
2011-12 Michael Traugott
2012-13 Joe Murphy
2013-14 Kristen Olson
2014-15 Allyson Holbrook
2015-16 Trent Buskirk
2016-17 Matthew Courser
2017-18 Ron Langley
2018-19 Ipek Bilgen
2019-20 Ned English
2020-21 Dana Garbarski
2021-22 Kevin Ulrich
2022-23 Justine Bulgar-Medina
2023-24 Leah Dean